

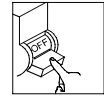

INSTALLATION INSTRUCTION

The installation and maintenance of this product must be by a professional. Please read this instruction sheet carefully before installation.



Do not operate with power supply connected.

CE Voltage: AC~220V~240V
Frequency: 50Hz

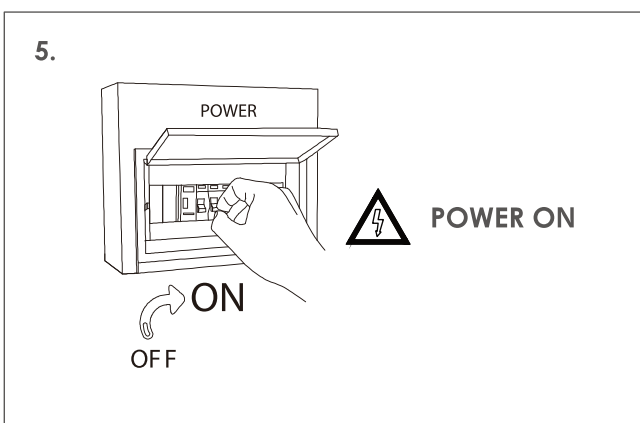
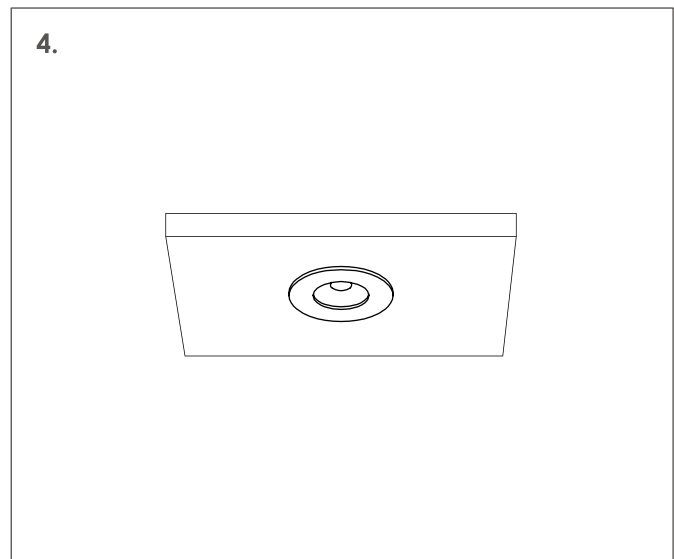
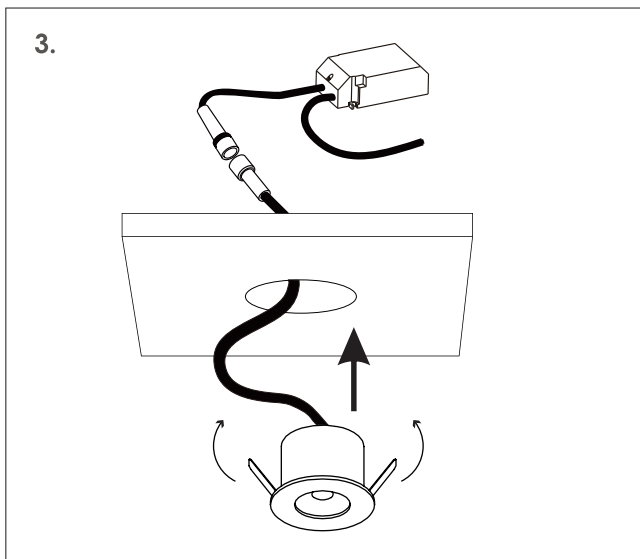
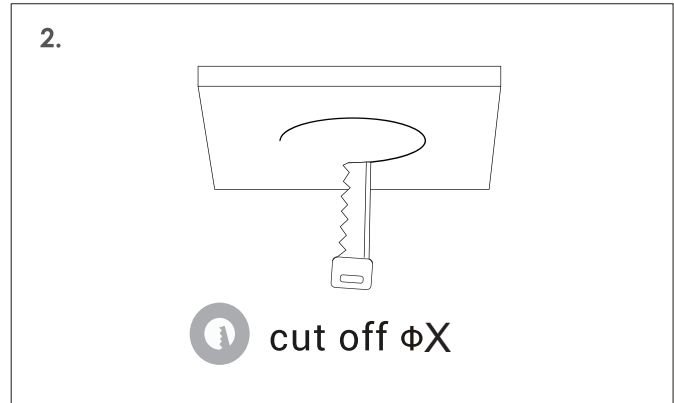
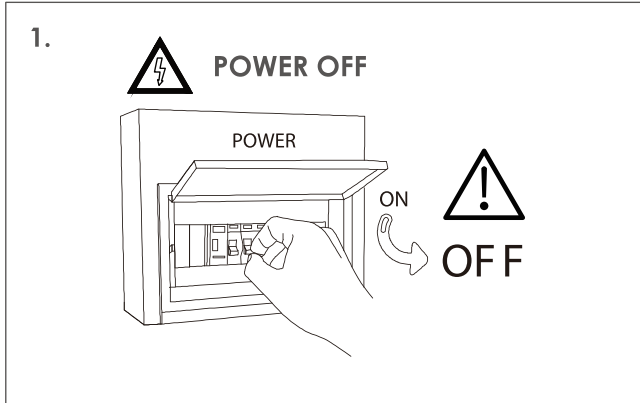

Model	Cut-out size (X)
SD011030R	$\Phi 30\text{mm}$
SD011030HR	$\Phi 30\text{mm}$
SD012040R	$\Phi 40\text{mm}$
SD011040HR	$\Phi 40\text{mm}$

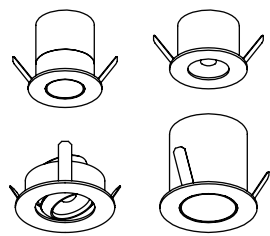

- 1 Disconnect the voltage from the system before performing the installation.
- 2 Cut ceiling hole in proper size in the ceiling as per required cut-out size and shape.
- 3 Connect power supply to power lead and pass the power supply through the ceiling opening.
- 4 Installation complete.
- 5 Restore voltage to the system.

