

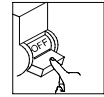

INSTALLATION INSTRUCTION

The installation and maintenance of this product must be by a professional. Please read this instruction sheet carefully before installation.



Do not operate with power supply connected.

CE Voltage: AC~220V~240V
Frequency: 50Hz

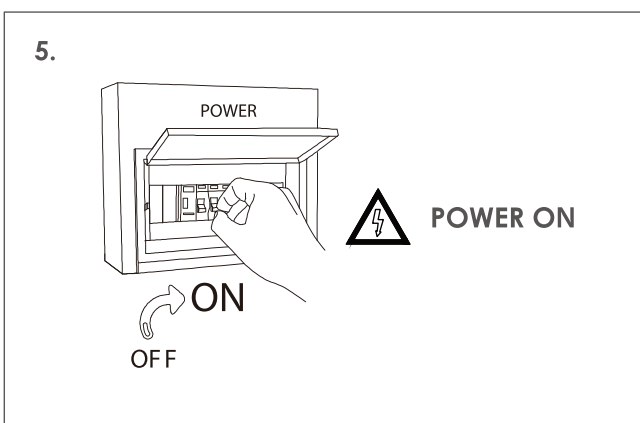
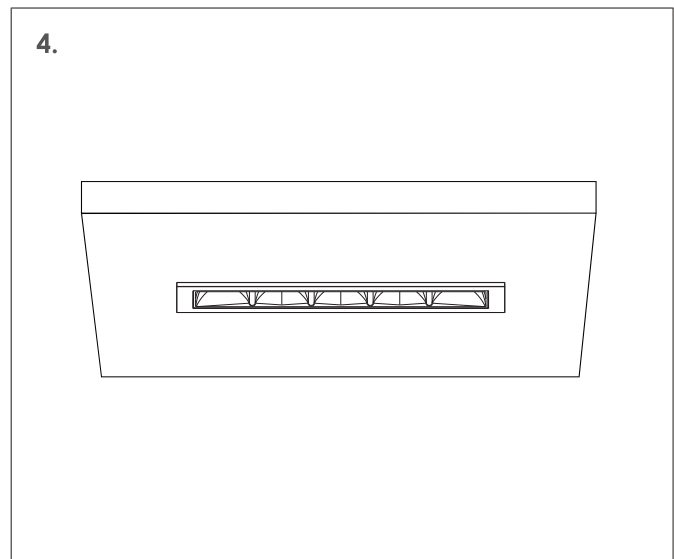
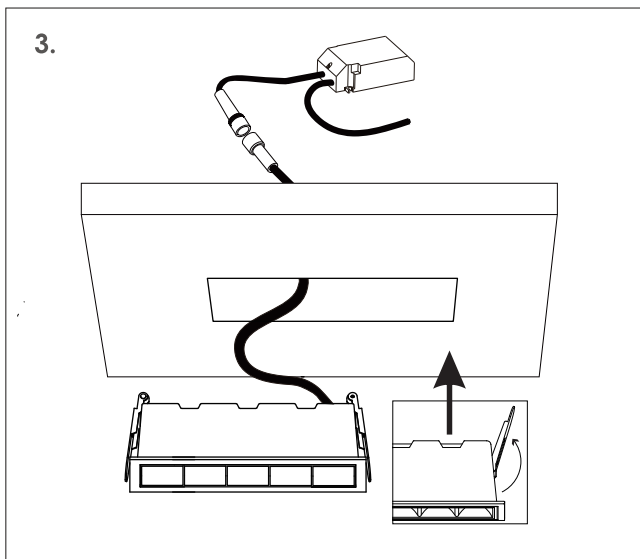
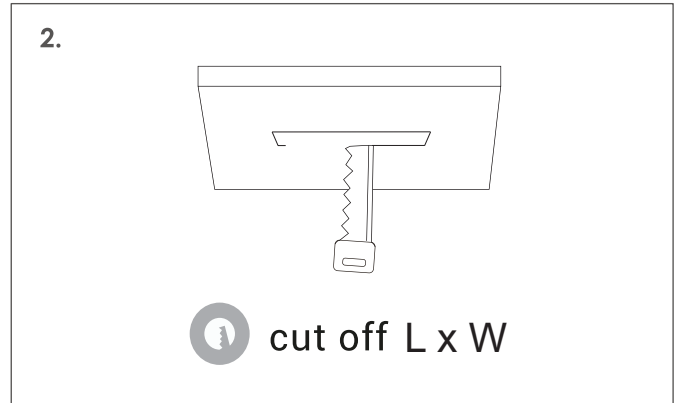
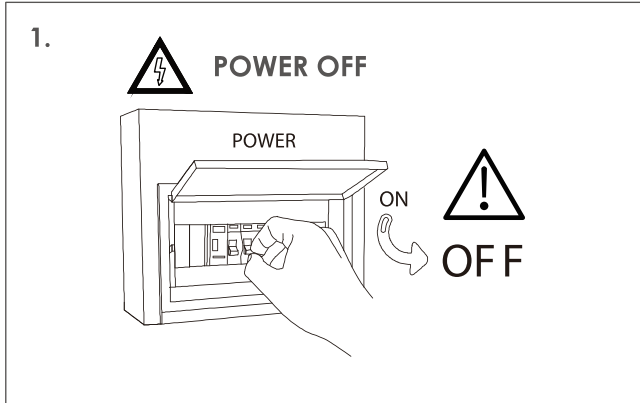

Model	Cut-out size (L)	Cut-out size (W)
SG80501037S	37mm	37mm
SG80502037S	68mm	37mm
SG80505037S	140mm	37mm
SG80501037S	273mm	37mm
SG80515037S	403mm	37mm

- 1 Disconnect the voltage from the system before performing the installation.
- 2 Cut ceiling hole in proper size in the ceiling as per required cut-out size and shape.
- 3 Connect power supply to power lead and pass the power supply through the ceiling opening.
- 4 Installation complete.
- 5 Restore voltage to the system.

